

## 32E Series - Endless Design Curved Glass - Single Duty - Deli



| Model No.              | Description    | Length | Depth | Height | Voltage | Amps | HP/BTUs | Power Cord | Est. Ship Weight |
|------------------------|----------------|--------|-------|--------|---------|------|---------|------------|------------------|
| <b>SC-CDS32E-4C-LS</b> | Self Contained | 50"    | 30.5" | 50.5"  | 115     | 12.0 | 1/4     | YES        | 500              |
| <b>SC-CDS32E-6C-LS</b> | Self Contained | 74"    | 30.5" | 50.5"  | 115     | 12.0 | 1/3     | YES        | 710              |
| <b>SC-CDS32E-8C-LS</b> | Self Contained | 98"    | 30.5" | 50.5"  | 115     | 16.0 | 1/2     | YES        | 940              |
| <b>R-CDS32E-4C-LS</b>  | Remote         | 50"    | 30.5" | 50.5"  | 115     | 1.4  | 1400    | NO         | 460              |
| <b>R-CDS32E-6C-LS</b>  | Remote         | 74"    | 30.5" | 50.5"  | 115     | 2.2  | 2100    | NO         | 660              |
| <b>R-CDS32E-8C-LS</b>  | Remote         | 98"    | 30.5" | 50.5"  | 115     | 2.8  | 2800    | NO         | 910              |

MODEL NUMBER PREFIX - SC = Self Contained R = Remote  
 MODEL NUMBER SUFFIX - W = White B = Black S = Stainless Steel LED = LED lighting  
 • Cases are designed to operate at 75 degrees Fahrenheit and 55% relative humidity  
 • Cases are equipped with drains; check your local building codes for connection requirements.  
 • Specification subject to change without notice  
 IF COLORS ARE MIXED AN ADDITIONAL CHARGE WILL APPLY



## 32E Series - Endless Design Curved Glass - Single Duty - Deli

### Standard Specifications and Optional Features

#### CONSTRUCTION

- UL Classified to ANSI/NSF 7
- Foamed in place CFC free foam
- Double pane coated and insulated curved glass
- Heavy gauge steel super structure
- Single duty display
- Endless design allows for continuous line up
- Drain is included for cleaning

#### INTERIOR

- Stainless steel mirrored upper ends
- Stainless steel heavy gauge lighted mezzanine shelf (1 row)
- White aluminum floor-main deck shelves
- Air insulated baffle (prevents moisture from dripping into display area)

#### EXTERIOR

- Double pane rear removable doors
- Newly designed rear compression door jamb
- Removable front grille allows for cleaning
- Removable rear grille for easy servicing
- 1" removeable end panels
- 1" Front bumper

#### FINISHES

- White, black, and stainless steel front and ends
- Stainless steel mirror trim
- Stainless steel heavy gauge top - 16" W
- Rear of unit is stainless steel brush finish at top
- Bottom rear is designer white or glossy black

#### LIGHTING

- 1 row of lighting at top of unit
- 1 row of lighting on mezzanine shelf

#### ELECTRICAL REQUIREMENTS

- 115V with powercord
- UL/CUL listed
- 115V-5AMP general purpose receptacle

#### REFRIGERATION

- Copevap system (eliminates need for condensate pan)
- R134a expansion valve system
- Gravity coil located at inside top of unit
- Self contained unit
- Automatic defrost electronically controlled (self contained units only)
- Electronically maintains constant temperatures
- Remotes available

#### OPTIONS

- Stainless steel, laminate, or paint
- Mirrored doors
- Extra stainless steel mezzanine shelf
- 2" Front bumper
- Door locks
- Pass thru front doors
- Sandwich racks
- Salad pan settings

#### Important Note:

**All refrigerated cases are designed to operate in an environment of 75 degrees and 55% relative humidity. Product must be cooled before being displayed within the case.**

**DRAIN IS REQUIRED**

## 32E Series - Endless Design Curved Glass - Single Duty - Deli

### Technical Data

| Model No.                      | SC<br>R     | SC-CDS32E-4C-LS<br>R-CDS32E-4C-LS | SC-CDS32E-6C-LS<br>R-CDS32E-6C-LS | SC-CDS32E-8C-LS<br>R-CDS32E-8C-LS |
|--------------------------------|-------------|-----------------------------------|-----------------------------------|-----------------------------------|
| Length with (2) ends           |             | 50"                               | 74"                               | 98"                               |
| Length without ends            |             | 48"                               | 72"                               | 96"                               |
| Height with ends               |             | 50.5"                             | 50.5"                             | 50.5"                             |
| Height without ends            |             | 50"                               | 50"                               | 50"                               |
| Depth with ends                |             | 30.5"                             | 30.5"                             | 30.5"                             |
| Depth without ends             |             | 30"                               | 30"                               | 30"                               |
| Endless design                 |             | YES                               | YES                               | YES                               |
| (Dimensions are +/- 1/4")      |             |                                   |                                   |                                   |
| Operating temperature          |             | 36°F to 40°F                      | 36°F to 40°F                      | 36°F to 40°F                      |
| Refrigerant (exp. valve)       | SC          | R134a                             | R134a                             | R134a                             |
| Refrigerant (exp. valve)       | R           | R407A                             | R407A                             | R407A                             |
| Compressor size HP             | SC          | 1/4                               | 1/3                               | 1/2                               |
| Defrost per day (24 hours)     | Air Defrost | 2 per day                         | 2 per day                         | 2 per day                         |
| BTU's at +20°F Evap. Temp.     | R           | 1400                              | 2100                              | 2800                              |
| Voltage                        | SC          | 115                               | 115                               | 115                               |
| Amperage                       | SC          | 12.0                              | 12.0                              | 16.0                              |
| Remote Voltage                 | R           | 115                               | 115                               | 115                               |
| Amperage, lights only          | R           | 1.4                               | 2.2                               | 2.8                               |
| Cord and plug                  | SC<br>R     | YES<br>NO                         | YES<br>NO                         | YES<br>NO                         |
| Exterior color                 |             | W, B, S                           | W, B, S                           | W, B, S                           |
| Interior color                 |             | W, B, S                           | W, B, S                           | W, B, S                           |
| Floors                         |             | W, B, S                           | W, B, S                           | W, B, S                           |
| # of top doors                 |             | 2                                 | 2                                 | 4                                 |
| Door size                      |             | 20.8" x 23.5"                     | 31.3" x 23.5"                     | 20.8" x 23.5"                     |
| # of coils                     |             | 1                                 | 1                                 | 1                                 |
| Bottom storage                 |             | NO                                | NO                                | NO                                |
| Front glass                    |             | Curved                            | Curved                            | Curved                            |
| # of main deck shelves         |             | 2                                 | 3                                 | 4                                 |
| Main deck size                 |             | 23.625" x 25"                     | 23.625" x 25"                     | 23.625" x 25"                     |
| Cubic capacity                 |             | 23                                | 34.5                              | 46                                |
| Mezzanine shelf, 1 row lighted |             | Standard                          | Standard                          | Standard                          |
| Shipping Info                  |             |                                   |                                   |                                   |
| Height                         |             | 55"                               | 55"                               | 55"                               |
| Depth                          |             | 44"                               | 44"                               | 44"                               |
| Length                         |             | 61"                               | 87"                               | 115"                              |
| Gross weight SC/R              |             | 500/460                           | 710/660                           | 940/910                           |
| Cubic feet                     |             | 85                                | 122                               | 161                               |

(ALL WHITE OR ALL BLACK, NO EXTRA CHARGE—IF COLORS ARE MIXED AN ADDITIONAL CHARGE WILL APPLY)

#### Prefix

SC = Self Contained  
R = Remote

#### Suffix

B = Black  
W = White  
S = Stainless Steel  
LS = T8 lighting  
LED = LED lighting

- Cases are designed to operate at 75 degrees Fahrenheit and 55% relative humidity
- Cases are equipped with drains; check your local building codes for connection requirements.
- Specification subject to change without notice

## 32E Series - Endless Design Curved Glass - Single Duty - Deli

### Technical Data • Side View • Plan View

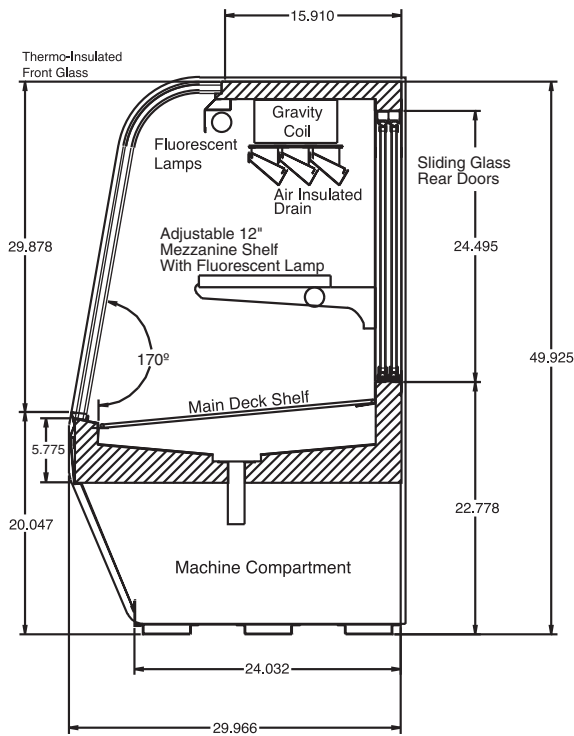

**Cross Section**

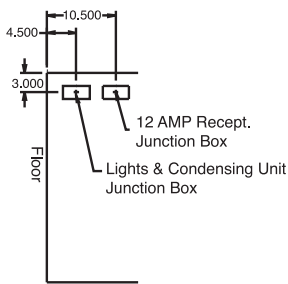
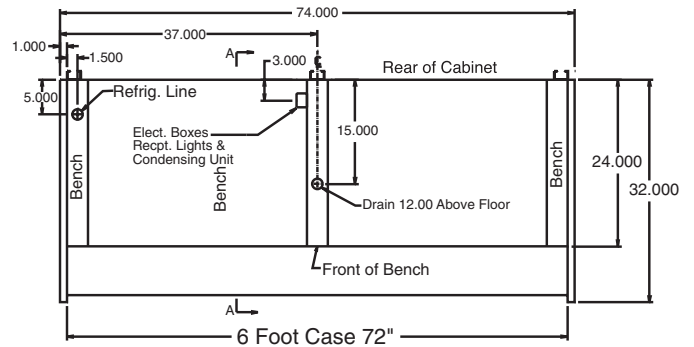
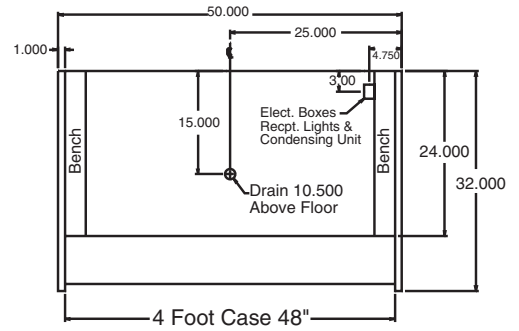

**Side View**

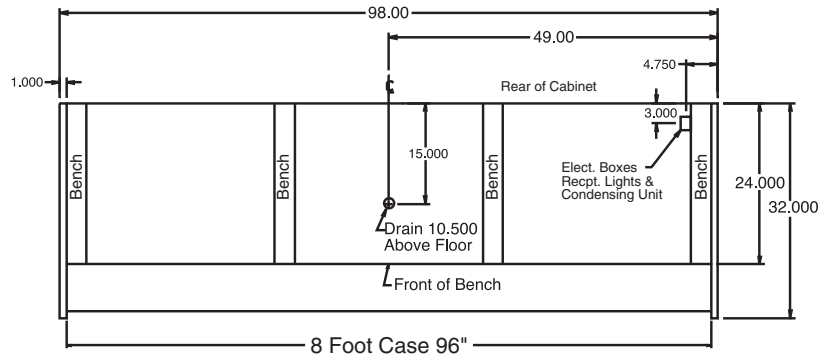

**Plan Views**